

Figure 170. Front Axle Differential Through Shaft, Gears, and Flange Assemblies.

Current part is item (34) on diagram. Available at www.oshkoshequipment.com

ILLUS.		SMR CODE	NATIONAL STOCK NUMBER	PART NUMBER	FSCM	DESCRIPTION USABLE ON CODE	U/M	QTY
(a) FIG. NO.	(b) ITEM NO.							INC IN UNIT
GROUP 1002 DIFFERENTIAL FIG.170 FRONT AXLE DIFFERENTIAL THROUGH SHAFT,GEARS AND FLANGE ASEMBLIES								
170	1	PAFZZ	5315-00-059-0184	MS24665-361	96906	PIN,COTTER	EA	2
170	2	PAFZZ3	5310-00-282-5661	7346893	19207	NUT,PLAIN,SLOTTED	EA	2
170	3	PAFFF	2520-00-734-6802	A3280G	78500	FLANGE,COMPANION	EA	2
				1957				
170	4	PAFZZ	2520-00-563-8309	7535048	19207	DEFLECTOR,DIRT	EA	1
170	5	PAFZZ	5305-00-018-0178	180178	24617	SCREW,CAP,HEXAGON	EA	8
170	6	PAFZZ	5310-00-249-6584	10947447	19207	WASHER,FLAT	EA	8
170	7	PAFFF	2520-00-734-6897	7346897	19207	COVER ASSEMBLY	EA	1
170	8	XAFZZ		8758251	19207	COVER,BEARING	EA	1
170	9	PAFZZ	5330-00-419-5872	10900396	19207	GASKET	EA	1
170	10	PAFZZ	5330-01-023-0269	A-1205-U-1737	78500	SEAL,PLAIN,ENCASED	EA	1
170	11	PAHZZ	5310-00-353-2427	7979263	19207	NUT,PLAIN	EA	1
170	12	PAHZZ	5310-00-147-3274	8758258	19207	WASHER,KEY	EA	1
170	13	PAHZZ	5310-00-700-7089	5139123	19207	WASHER,KEY	EA	1
170	14	PAHZZ	3110-00-419-9471	8758202	19207	PLATE,RETAINING	EA	1
170	15	KFHZZ		7346888	19207	SHIM .003,PART OF KIT P/N 7346807	EA	1
170	15	KFHZZ		7346889	19207	SHIM .005,PART OF KIT P/N 7340807	EA	1
170	15	KFHZZ		7346890	19207	SHIM .010,PART OF KIT P/N 7340807	EA	1
170	16	KFHZZ		8758209	19207	SPACER .367,PART OF KIT P/N 5704278	EA	1
170	16	KFHZZ		8758211	19207	SPACER .369,PART OF KIT P/N 5704278	EA	1
170	16	KFHZZ		8758213	19207	SPACER .371,PART OF KIT P/N 5704278	EA	1
170	16	KFHZZ		8758215	19207	SPACER .373,PART OF KIT P/N 5704278	EA	1
170	16	KFHZZ		8758217	19207	SPACER .375,PART OF KIT P/N 5704278	EA	1
170	16	KFHZZ		8758219	19207	SPACER .377,PART OF KIT P/N 5704278	EA	1
170	16	KFHZZ		8758221	19207	SPACER .379,PART OF KIT P/N 5704278	EA	1
170	16	KFHZZ		8758223	19207	SPACER .381,PART OF KIT P/N 5704278	EA	1
170	16	KFHZZ		8758225	19207	SPACER .383,PART OF KIT P/N 5704278	EA	1
170	16	KFHZZ		8758227	19207	SPACER .385,PART OF KIT P/N 5704278	EA	1
170	16	KFHZZ		8758229	19207	SPACER .387,PART OF KIT P/N 5704278	EA	1
170	16	KFHZZ		8758231	19207	SPACER .389,PART OF KIT P/N 5704278	EA	1
170	16	KFHZZ		8758233	19207	SPACER .391,PART OF KIT P/N 5704278	EA	1
170	16	KFHZZ		8758235	19207	SPACER .393,PART OF KIT P/N 5704278	EA	1
170	16	KFHZZ		8758237	19207	SPACER .395,PART OF KIT P/N 5704278	EA	1
170	16	KFHZZ		8758239	19207	SPACER .397,PART OF KIT P/N 5704278	EA	1
170	16	KFHZZ		8758241	19207	SPACER .399,PART OF KIT P/N 5704278	EA	1
170	16	KFHZZ		8758243	19207	SPACER .401,PART OF KIT P/N 5704278	EA	1
170	16	KFHZZ		8758245	19207	SPACER .403,PART OF KIT P/N 5704278	EA	1
170	17	PAHZZ	3110-00-100-5335	713536	21450	BEARING,ROLLER	EA	1
170	18	PAHZZ	3040-00-734-6892	7346892	19207	SHAFT,SHOULDERED	EA	1
170	19	PAHZZ	3110-00-195-0460	712148	78500	BEARING,ROLLER	EA	1
170	20	PAHZZ	3120-00-662-3370	7346894	19207	BEARING,WASHER	EA	1

Current part is item (34) on diagram. Available at www.oshkoshequipment.com

Current part is item (34) on diagram. Available at www.oshkoshequipment.com

ILLUS. (a) FIG. NO.	(b) ITEM NO.	SMR CODE	NATIONAL STOCK NUMBER	PART NUMBER	FSCM	DESCRIPTION USABLE ON CODE	U/M	QTY INC IN UNIT
170	21	PAFFF	2520-00-734-6895	7346895	19207	CAP AND SEAL ASSEMBLY	EA	1
170	22	XAFZZ		8758207	19207	CAP	EA	1
170	23	PAFZZ	5330-01-023-0269	A-1205-U-1737	78500	SEAL,PLAIN ENCASED	EA	1
170	24	PAFZZ	5305-00-543-2419	MS90728-61	96906	SCREW,CAP,HEXAGON	EA	6
170	25	PAFZZ	5310-00-637-9541	MS35338-46	96906	WASHER,LOCK	EA	6
170	26	PAHZZ	5330-00-641-2466	7346896	19207	GASKET PART OF KIT P/N 7346807	EA	1
170	27	PAHZZ	3020-00-734-6881	7346881	19207	GEAR SET	EA	1
170	28	XAHZZ		8758204	19207	PINION,BEVEL	EA	1
170	29	XAHZZ		8758205	19207	GEAR,BEVEL	EA	1
170	30	PAHZZ	5310-00-374-0836	7979308	19207	NUT,PLAIN	EA	1
170	31	XAHZZ		7979309	19207	NUT,PLAIN	EA	1
170	32	XAHZZ		7979310	19207	PIN,ADJUSTMENT	EA	1
170	33	PAHZZ	3110-00-100-4177	703189	21450	BEARING,ROLLER	EA	1
170	34	PAHZZ	5330-00-734-6886	7346886	19207	GASKET	EA	1

END OF FIGURE



Current part is item (34) on diagram. Available at www.oshkoshequipment.com

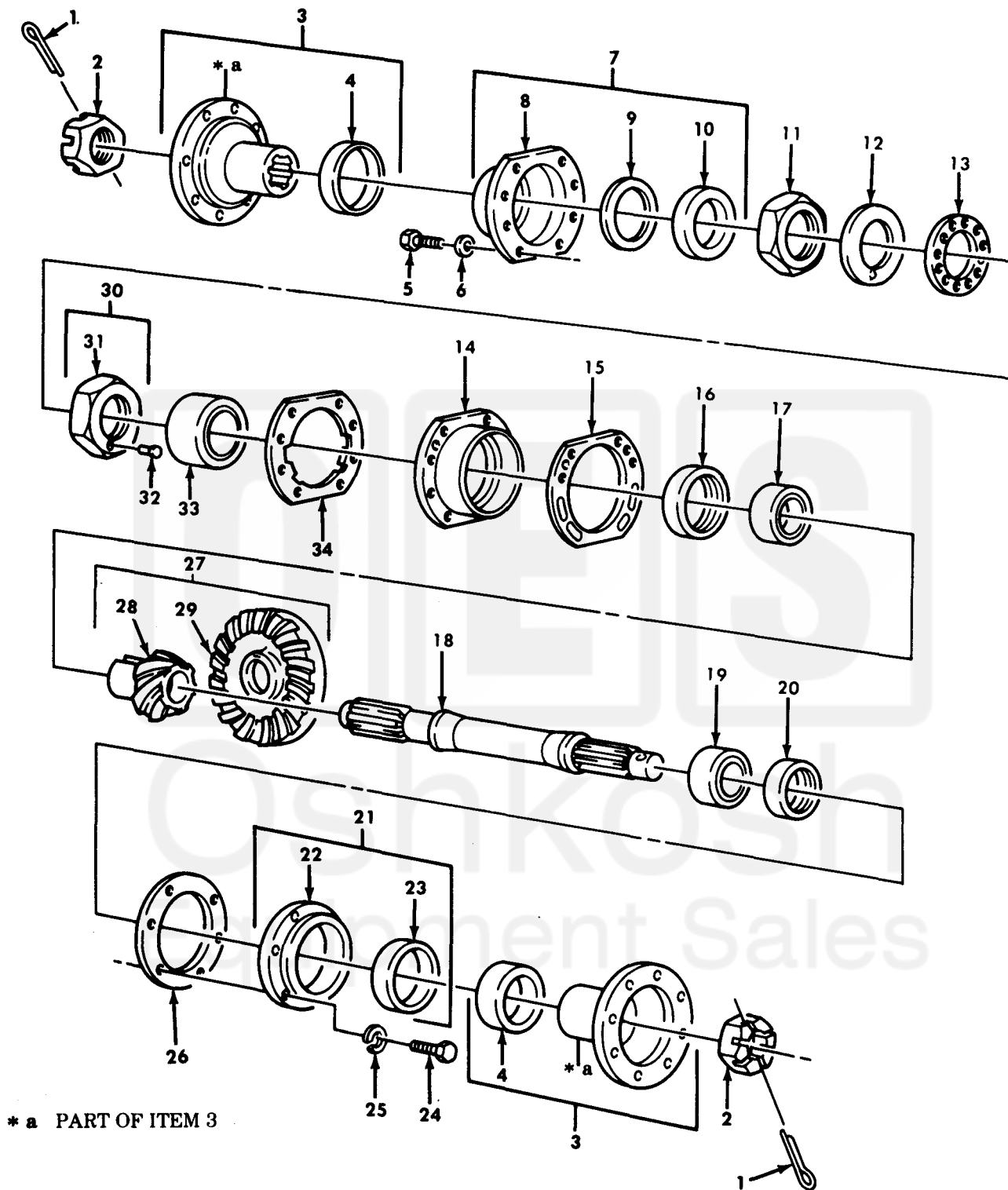

TA 467909

Figure 176. Rear Axle Differential Through Shaft, Gears, and Flange Assemblies.

Current part is item (34) on diagram. Available at www.oshkoshequipment.com

ILLUS. (a) FIG. NO.	(b) ITEM NO.	SMR CODE	NATIONAL STOCK NUMBER	PART NUMBER	FSCM	DESCRIPTION USABLE ON CODE	U/M	QTY INC IN UNIT
GROUP 1102 DIFFERENTIAL								
FIG.176 REAR AXLE DIFFERENTIAL THROUGH								
SHAFT,GEARS,AND FLANGE ASSEMBLIES								
176	1	PAFZZ	5315-00-059-0184	MS24665-361	96906	PIN,COTTER	EA	2
176	2	PAFZZ	5310-00-282-5661	7346893	19207	NUT,PLAIN,SLOTTED	EA	2
176	3	PAFFF	2520-00-734-6802	A3280G	78500	FLANGE,TRANSFER	EA	2
				1957				
176	4	PAFZZ	2520-00-563-8309	7535048	19207	DEFLECTOR,DIRT	EA	1
176	5	PAFZZ	5305-00-018-0178	180178	24617	SCREW,CAP,HEXAGON	EA	8
176	6	PAFZZ	5310-00-249-6584	10947447	19207	WASHER,FLAT	EA	8
176	7	PAFFF	2520-00-734-6897	7346897	19207	COVER ASSEMBLY	EA	1
176	8	XAFZZ		8758251	19207	COVER	EA	1
176	9	PAFZZ	5330-00-419-5872	10900396	19207	GASKET	EA	1
176	10	PAFZZ	5330-01-023-0269	A-1205-U-1737	78500	SEAL,PLAIN ENCASED	EA	1
176	11	PAHZZ	5310-00-353-2427	7979263	19207	NUT,PLAIN	EA	1
176	12	PAHZZ	5310-00-147-3274	8758258	19207	WASHER,KEY	EA	1
176	13	PAHZZ	5310-00-700-7089	5139123	19207	WASHER,KEY	EA	1
176	14	PAHZZ	3110-00-419-9471	8758202	19207	PLATE,RETAINING	EA	1
176	15	KFHZZ		7346888	19207	SHIM .003,PART OF KIT P/N 7346807	EA	1
176	15	KFHZZ		7346889	19207	SHIM .005,PART OF KIT P/N 7346807	EA	1
176	15	KFHZZ		7346890	19207	SHIM .010,PART OF KIT P/N 7346807	EA	1
176	16	KFHZZ		8758209	19207	SPACER .367,PART OF KIT P/N 5704278	EA	1
176	16	KFHZZ		8758211	19207	SPACER .369,PART OF KIT P/N 5604278	EA	1
176	16	KFHZZ		8758213	19207	SPACER .371,PART OF KIT P/N 5604278	EA	1
176	16	KFHZZ		8758215	19207	SPACER .373,PART OF KIT P/N 5604278	EA	1
176	16	KFHZZ		8758217	19207	SPACER .375,PART OF KIT P/N 5604278	EA	1
176	16	KFHZZ		8758219	19207	SPACER .377,PART OF KIT P/N 5604278	EA	1
176	16	KFHZZ		8758221	19207	SPACER .379,PART OF KIT P/N 5604278	EA	1
176	16	KFHZZ		8758223	19207	SPACER .381,PART OF KIT P/N5604278	EA	1
176	16	KFHZZ		8758225	19207	SPACER .383,PART OF KIT P/N5604278	EA	1
176	16	KFHZZ		8758227	19207	SPACER .385,PART OF KIT P/N 5604278	EA	1
176	16	KFHZZ		8758229	19207	SPACER .387,PART OF KIT P/N 5604278	EA	1
176	16	KFHZZ		8758231	19207	SPACER .389,PART OF KIT P/N 5604278	EA	1
176	16	KFHZZ		8758233	19207	SPACER .391,PART OF KIT P/N 5604278	EA	1
176	16	KFHZZ		8758235	19207	SPACER .393,PART OF KIT P/N 5604278	EA	1
176	16	KFHZZ		8758237	19207	SPACER .395,PART OF KIT P/N 5604278	EA	1
176	16	KFHZZ		8758239	19207	SPACER .397,PART OF KIT P/N 5604278	EA	1
176	16	KFHZZ		8758241	19207	SPACER .399,PART OF KIT P/N 5604278	EA	1
176	16	KFHZZ		8758243	19207	SPACER .401,PART OF KIT P/N 5604278	EA	1
176	16	KFHZZ		8758245	19207	SPACER .403,PART OF KIT P/N 5604278	EA	1
176	17	PAHZZ	3110-00-100-5355	713536	21450	BEARING,ROLLER	EA	1
176	18	PAHZZ	3040-00-734-6892	7346892	19207	SHAFT,SHOULDERED	EA	1
176	19	PAHZZ	3110-00-195-0460	712148	78500	BEARING ROLLER	EA	1
176	20	PAHZZ	3120-00-662-3370	7346894	19207	BEARING,WASHER	EA	1

Current part is item (34) on diagram. Available at www.oshkoshequipment.com

Current part is item (34) on diagram. Available at www.oshkoshequipment.com

ILLUS.						QTY	
(a)	(b)	SMR	NATIONAL	PART	DESCRIPTION	U/M	INC
FIG.	ITEM	CODE	STOCK	NUMBER	FSCM		IN
NO.	NO.		NUMBER		USABLE ON CODE		UNIT
176	21	PAFFF	2520-00-734-6895	7346895	19207	CAP AND SEAL ASSEMBLY	EA 1
176	22	XAFZZ	8758207	8758207	19207	CAP	EA 1
176	23	PAFZZ	5330-01-023-0269	A-1205-U-1737	78500	SEAL,PLAIN,ENCASED	EA 1
176	24	PAFZZ	5305-00-543-2419	MS90728-61	96906	SCREW,CAP,HEXAGON	EA 6
176	25	PAFZZ	5310-00-637-9541	MS35338-46	96906	WASHER,LOCK	EA 6
176	26	KPHZZ	5330-00-641-2466	7346896	19207	GASKET PART OF KIT P/N 7346807	EA 1
176	27	PAHZZ	3020-00-734-6881	7346881	19207	GEAR SET	EA 1
176	28	XAHZZ	8758204	8758204	19207	PINION,BEVEL	EA 1
176	29	XAHZZ	8758205	8758205	19207	GEAR,BEVEL	EA 1
176	30	PAHZZ	5310-00-374-0836	7979308	19207	NUT,PLAIN	EA 1
176	31	XAHZZ	7979309	7979309	19207	NUT,PLAIN	EA 1
176	32	XAHZZ	7979310	7979310	19207	PIN,ADJUSTMENT	EA 1
176	33	PAHZZ	3110-00-100-4177	703189	21450	BEARING,ROLLER	EA 1
176	34	PAHZZ	5330-00-734-6886	7346886	19207	GASKET PART OF KIT P/N 7346807	EA 1

END OF FIGURE



Current part is item (34) on diagram. Available at www.oshkoshequipment.com